

# OVERALL SOLUTION TO ENVIRONMENTAL FRIENDLY REFRIGERANTS FILLING 环境友好制冷剂充注及安全整体解决方案

SCHENCK SHANGHAI MACHINERY – AGRAMKOW  
上海申克机械有限公司 - 安科中国

# FEATURE 冷媒特性

	ODP 臭氧消耗潜能值	GWP 全球变暖潜能值	Mass 分子量	L.E.L (% v/v)	U.E.L (% v/v)	Class 等级
R290	0	0.01	44.9	2.1	9.5	A3
R32	0	0.11	52.0	14.0	31.0	A2 (A2L)
R22	0.045	1662	86.48			
R410a	0.000	2612	72.58			

- **Replace R22/R410a**      用于替代 R22/R410a
- **Environmental Friendly**      环保工质
- **Flammable!**      可燃工质

**安全!**



# EXPLOSION TRIANGLE 危险（爆炸）的条件

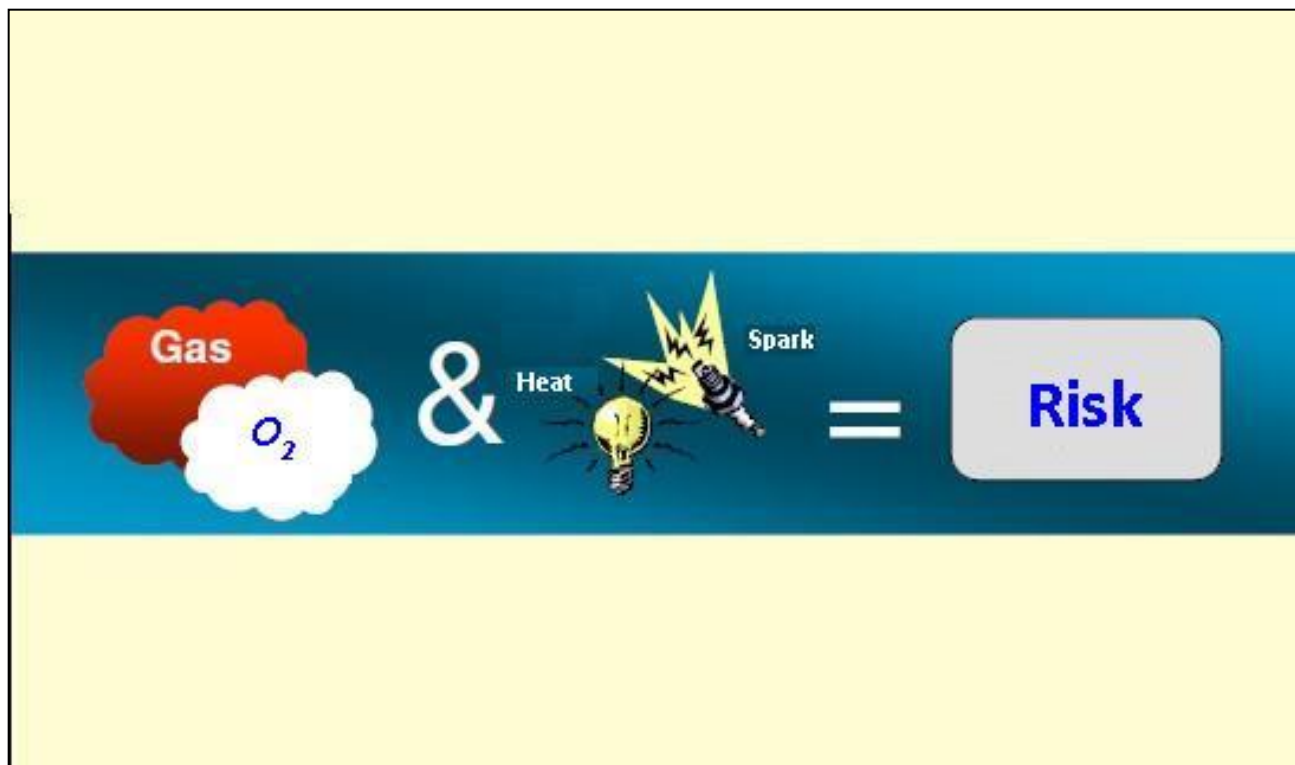

# HOW? 如何解决



## Working Area工作区域:

- » ATEX 1999/92/EC
- » 当地规范《使用可燃性制冷剂生产家用和类似用途房间空调器安全技术规范》  
(实施日期: 2017-04-01)
- » End user responsibility  
用户责任

## Equipment Manufacturer设备:

- » ATEX 2014/34/EU
- » Manufacturer responsibility  
设备供应商责任

# SOLUTION 如何解决

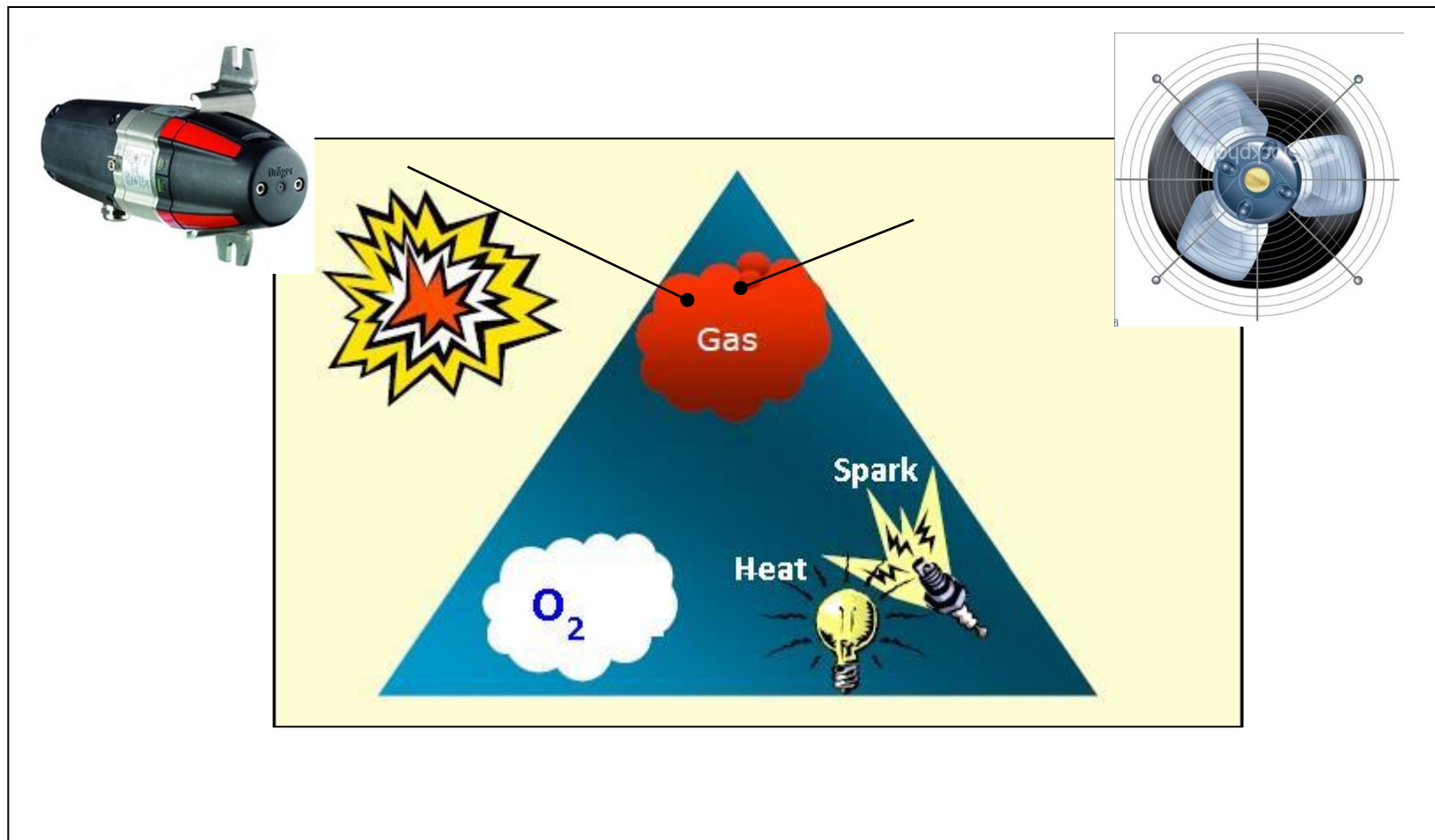

# R290 CASE项目案例 — 中国客户



- |               |                  |
|---------------|------------------|
| 1. 珠海格力空调     | R290生产线交钥匙工程     |
| 2. 广东美的空调     | R290生产线交钥匙工程     |
| 3. 滁州扬子空调     | R290生产线交钥匙工程     |
| 4. 四川长虹空调     | R290生产线交钥匙工程     |
| 5. 芜湖格力空调     | R290生产线安全&通风系统   |
| 6. 芜湖美的空调     | R290生产线交钥匙工程     |
| 7. 宁波奥克斯空调    | R290生产线交钥匙工程     |
| 8. 江门海信空调     | R290生产线交钥匙工程     |
| 9. 合肥海尔空调     | R290生产线安全&通风系统   |
| 10. 广东美的空调    | R290试生产线交钥匙工程    |
| 11. 芜湖美智空调    | R290生产线交钥匙工程     |
| 12. 广东顺德海信冷柜  | R290冷媒充注机及安全系统   |
| 13. 澳柯玛股份有限公司 | R290冷媒充注机及安全系统   |
| 14. 杭州马尼托瓦    | R290冷媒充注机及安全通风系统 |
| 15. 上海富申冷机    | R290冷媒充注机及安全通风系统 |

- 1条线, 2009年通过TÜV认证
- 1条线, 2013年通过TÜV认证
- 1条线, 2014年通过TÜV认证
- 1条线, 2015年通过TÜV认证
- 2条线, 2015年通过TÜV认证
- 1条线, 2016年通过TÜV认证
- 1条线, 2016年通过TÜV认证
- 1条线, 2016年通过TÜV认证
- 1条线, 含TÜV认证
- 1条线, 含TÜV认证
- 1条线, 含TÜV认证





## CASE #1 成功案例



全球第1条示范线：  
珠海格力空调  
完成认证时间：2009年

R290 turn-key line in GREE Zhuhai  
安科为格力电器提供交钥匙工程  
(世界首条R290分体空调生产线)



安科为格力电器提供交钥匙工程

# CERTIFICATE

No. TÜV- IS-UL 1 528 804

This is to certify that

**Object:** R 290-Charging Plants  
for Production of Air Conditioner  
Safety Equipment

**Supplier:** Agramkow, Fluid Systems A/S  
DK-6400 Sonderborg

**Operator:** Gree Electric Appliances Inc.  
Jinji West Rd.;Zhu Hai,  
Guangdong; P.R. China

meets the requirements of the TÜV SÜD Industrie Service GmbH.  
It was installed according to the relevant International Standards.  
The charging plant with Propane as refrigerant has been  
submitted to an audit to verify compliance with the state  
of the art. The system was audited in the period  
from 26<sup>th</sup> September to 1<sup>st</sup> October 2010.

This Certification is based on Final Report  
Safety Inspection of R 290 Charging PLANT  
Project: GTZ-Gree Propane Charging Plants

TÜV IS-ULM-Ri/Ga  
File No.: GTZ/GRE-PRC-03/10

This Certification is valid until  
30<sup>th</sup> September 2013

Ulm, 4<sup>th</sup> December 2010  
TÜV SÜD Industrie Service experts

K-J Richardt

B. Gassebner

TÜV SÜD Industrie Service GmbH, Niederlassung Ulm, Benzstrasse 17 D-89079 Ulm  
Tel. +49 (731) 49 15-2 30 Fax +49 (731) 49 15-3 40 e-mail: Karl-Josef.Richardt@tuev-sued.de

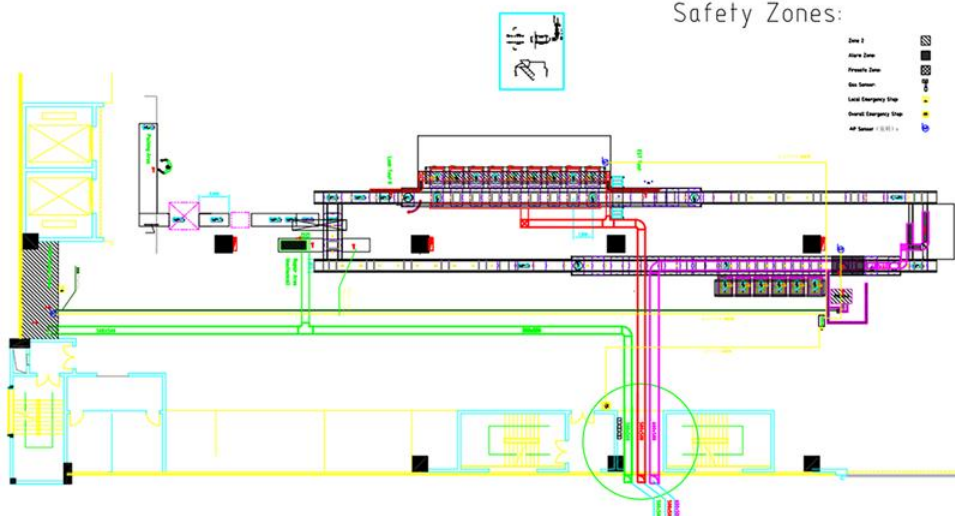



## CASE #2 成功案例



示范线：  
广东美的空调  
完成认证时间：2013年



R290 turn-key line in Midea Shunde  
安科为美的空调提供交钥匙工程



# 安科为美的空调提供交钥匙工程

2013-05-05-03-Safety-Inspection-ver101

TÜV RHEINLAND (China) Ltd.

Member of TÜV Rheinland Group



## CERTIFICATE

Of Safety Inspection In Regards Of Explosion Safety

Orderno.: 1140008330

Scope: R-290 Charging plant at Midea factory No. 9 Workshop,  
Project Number Agramkow 40998.

Requirement(s): European Directive for Explosion Protection ATEX 1999/92/EC  
The relevant code(s) and standard(s) defined by TÜV Rheinland in regards of Explosion Safety  
(See inspection report for details)

Applicant: Schenck Shanghai Machinery Co., Ltd. – Agramkow  
2<sup>nd</sup> Floor, No. 1111 Fengxiang Road,  
Bao Shan District, Shanghai 200444  
PR China

Location: Guangdong Midea Refrigeration Equipment Co.,Ltd.  
No. 9 Workshop – 5<sup>th</sup> Industrial AREA Midea  
Ling Gang, Bei Jiao Town  
Shunde District Foshan City 528311  
PR China

User: Guangdong Midea Refrigeration Equipment Co., Ltd.

The inspection plan and results are listed in the confidential inspection report no. 16802442.

This is to certify that the installation meets the basic requirements as listed in the inspection report in regards of Explosion Safety. This certificate follows the certification rules agreed and signed between all parties. The safety is only continuously met when all safety procedures are followed which are defined in the confidential inspection report.

This certificate shall only be reproduced in its entire and without any change.

Date: 15.11.2013  
Expiry Date: 15.11.2014



*Thomas Fuhrmann*  
Dipl.-Ing. Thomas Fuhrmann  
Director Industrial Services,  
Greater China

TÜV Rheinland (China) Ltd. – Industrial Services – Unit 707, AVIC Bldg., No. 10B, Central Road, East 3<sup>rd</sup> Ring Road, Chaoyang District, Beijing, 100022, P.R. China

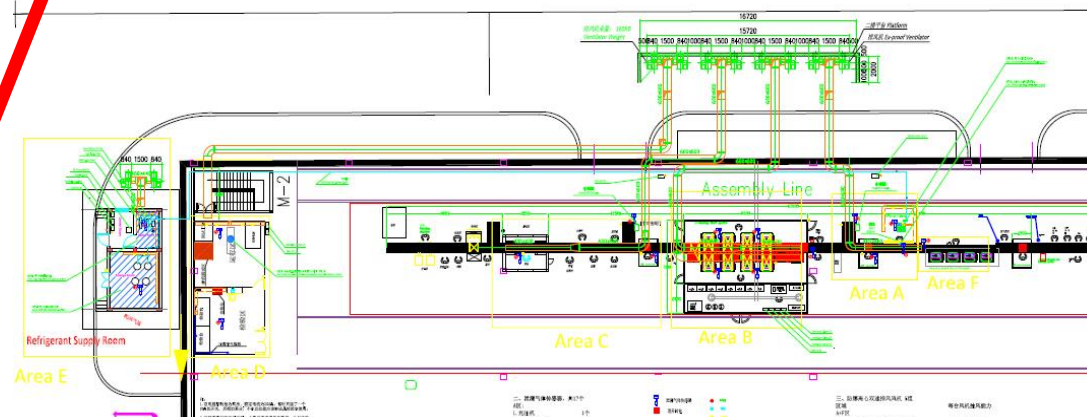

# CERTIFICATE R290项目TÜV证书



TÜV RHEINLAND (China) Ltd.  
Member of TÜV Rheinland Group

**CERTIFICATE**

Of Safety Inspection In Regard Of Explosion Safety

Order no.: 11/0008333

Scope: R 290 Charging plant in Midas Factory No. 9 Workshop,  
Project Number Agreement 40956.

Requirements: European Directive for Explosive Protection ATEX 2002/76/EC  
The relevant codes and standards defined by TÜV Rheinland in regards of Explosion Safety  
(See inspection report for details)

Applicant: Schenck Shanghai Machinery Co., Ltd. - Agrarwerk  
27 Floor, No. 1111 Fongqing Road,  
Jiao Jiao District, Shanghai 200444  
PR China

Location: Guangdong Midas Refrigeration Equipment Co., Ltd.  
No. 5 Workshop - 5<sup>th</sup> Industrial Area Midas  
Ling Sheng, 30 Jiao Town  
Shenhe District, Taizhou City 320111  
PR China

User: Guangdong Midas Refrigeration Equipment Co., Ltd.

The inspection plan and results are linked to the confidential inspection report no. 15002845.

This is to certify that the installation meets the basic requirements as listed in the inspection report in regards of Explosion Safety. This certificate follows the certification rules agreed and signed between all parties. The safety is only continuously met when all safety procedures are followed which are defined in the confidential inspection report.

This certificate shall only be reproduced in its entire and without any change.

Date: 19.11.2023  
Expiry Date: 19.11.2024

TÜV Rheinland (China) Ltd. - Industrial Services - Unit 707, AWC Bldg., No. 108, Central Road, East 3<sup>rd</sup> Ring Road, Chaoyang District, Beijing, 100022, P.R. China

顺德美的R290项目

芜湖美的R290项目

TÜV RHEINLAND (China) Ltd.  
Member of TÜV Rheinland Group

**CERTIFICATE**

Of Safety Inspection In Regard Of Explosion Safety

Order no.: 214001333

Scope: R 290 Charging plant in Yong Factory No. 3 Workshop,  
Project Number Agreement 483002117

Requirements: European Directive for Explosive Protection ATEX 2002/76/EC  
The relevant codes and standards defined by TÜV Rheinland in regards of Explosion Safety  
(See inspection report for details)

Applicant: Schenck Shanghai Machinery Co., Ltd. - Agrarwerk  
27 Floor, No. 1111 Fongqing Road,  
Jiao Jiao District, Shanghai 200444  
PR China

Location: CHINA YANGZI GROUP CHUZHOU YANGZI AIR CONDITIONER CO., LTD  
1602006 Shanghai North Road,  
Economic & Technology Development Zone,  
Chuzhou City, Anhui Province,  
PR China

User: CHINA YANGZI GROUP CHUZHOU YANGZI AIR CONDITIONER CO., LTD

The inspection plan and results are linked to the confidential inspection report no. 15002422\_000

This is to certify that the installation meets the basic requirements as listed in the inspection report in regards of Explosion Safety. This certificate follows the certification rules agreed and signed between all parties. The safety is only continuously met when all safety procedures are followed which are defined in the confidential inspection report.

This certificate shall only be reproduced in its entire and without any change.

Date: 17.10.2024  
Expiry Date: 18.10.2025

TÜV Rheinland (China) Ltd. - Industrial Services - Unit 707, AWC Bldg., No. 108, Central Road, East 3<sup>rd</sup> Ring Road, Chaoyang District, Beijing, 100022, P.R. China

滁州扬子R290项目

江门海信R290项目

TÜV RHEINLAND (China) Ltd.  
Member of TÜV Rheinland Group

**CERTIFICATE**

Of Safety Inspection In Regard Of Explosion Safety

Order no.: 151001390

Scope: R 290 Charging plant in north side of Changhong factory 30th Workshop  
Project Number Agreement 480300010

Requirements: European Directive for Explosive Protection ATEX 2002/76/EC  
The relevant codes and standards defined by TÜV Rheinland in regards of Explosion Safety  
(See inspection report for details)

Applicant: Schenck Shanghai Machinery Co., Ltd.  
Agrarwerk and floor, No. 1111 Fongqing Road, Jiao Jiao District, Shanghai, PR China  
(See inspection report for details)

Location: SICHUAN CHANGHONG AIR CONDITIONING CO., LTD.  
No. 35, Eastmining Road, High-Tech Park, Mingyong, Sichuan, P.R. China  
(Zip Code: 623000)

User: SICHUAN CHANGHONG AIR CONDITIONING CO., LTD.

The inspection plan and results are linked to the confidential inspection report no. 15077315.000

This is to certify that the installation meets the basic requirements as listed in the inspection report in regards of Explosion Safety. This certificate follows the certification rules agreed and signed between all parties. The safety is only continuously met when all safety procedures are followed which are defined in the confidential inspection report.

This certificate shall only be reproduced in its entire and without any change.

Date: 27.03.2025  
Expiry Date: 26.03.2026

TÜV Rheinland (China) Ltd. - Industrial Services - Unit 707, AWC Bldg., No. 108, Central Road, East 3<sup>rd</sup> Ring Road, Chaoyang District, Beijing, 100022, P.R. China

绵阳长虹R290项目

芜湖格力R290项目

TÜV RHEINLAND (China) Ltd.  
Member of TÜV Rheinland Group

**CERTIFICATE**

Of Safety Inspection In Regard Of Explosion Safety

Order no.: 15412404

Scope: R 290 Charging plant in north side of Oakes Rise in Jiao workshop, AJA and Industrial  
Park 8th  
Project Number Agreement 480010040

Requirements: European Directive for Explosive Protection ATEX 2002/76/EC  
The relevant codes and standards defined by TÜV Rheinland in regards of Explosion Safety  
(See inspection report for details)

Applicant: Schenck Shanghai Machinery Co., Ltd.  
Agrarwerk and floor, No. 1111 Fongqing Road, Jiao Jiao District, Shanghai, PR China  
(Zip Code: 200444)

Location: Ningbo OX Air-Conditioning Co., Ltd.  
No. 1105, North Ming Road, Jiao Jiao Industrial Park Area, Ningbo City, Zhejiang  
P.R. China  
(Zip Code: 315005)

User: Ningbo OX Air-Conditioning Co., Ltd.

The inspection plan and results are linked to the confidential inspection report no. 15077315.000

This is to certify that the installation meets the basic requirements as listed in the inspection report in regards of Explosion Safety. This certificate follows the certification rules agreed and signed between all parties. The safety is only continuously met when all safety procedures are followed which are defined in the confidential inspection report.

This certificate shall only be reproduced in its entire and without any change.

Date: 16.01.2024  
Expiry Date: 15.01.2025

TÜV Rheinland (China) Ltd. - Industrial Services - Unit 707, AWC Bldg., No. 108, Central Road, East 3<sup>rd</sup> Ring Road, Chaoyang District, Beijing, 100022, P.R. China

宁波奥克斯R290项目



# NATIONAL STANDARD 行业国标

各位同事，大家好！

我们共同完成的生产可燃性制冷剂房间空调器行业标准已经获得工信部批准并发布，2017年4月实施。附件是公告照片和这次批准的行业标准列表，供各位参考。

再次感谢工作组中各位对于标准制定所做出的贡献，希望后期这个工作组还能继续一起工作，希望各位保持联系！

祝好

## 使用可燃性制冷剂生产家用和类似用途制 冷器具安全技术规范

Safety technical code for using isobutane as refrigerant  
in household and similar refrigerating appliances industry

《使用可燃性制冷剂生产家用和类似用途房间空调器安全技术规范》  
(实施日期：2017-04-01)



# 1. PRE-ENGINEERING 项目方案设计

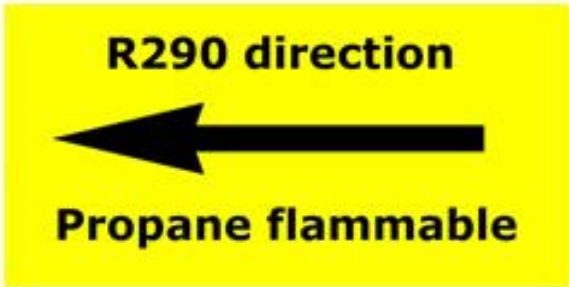
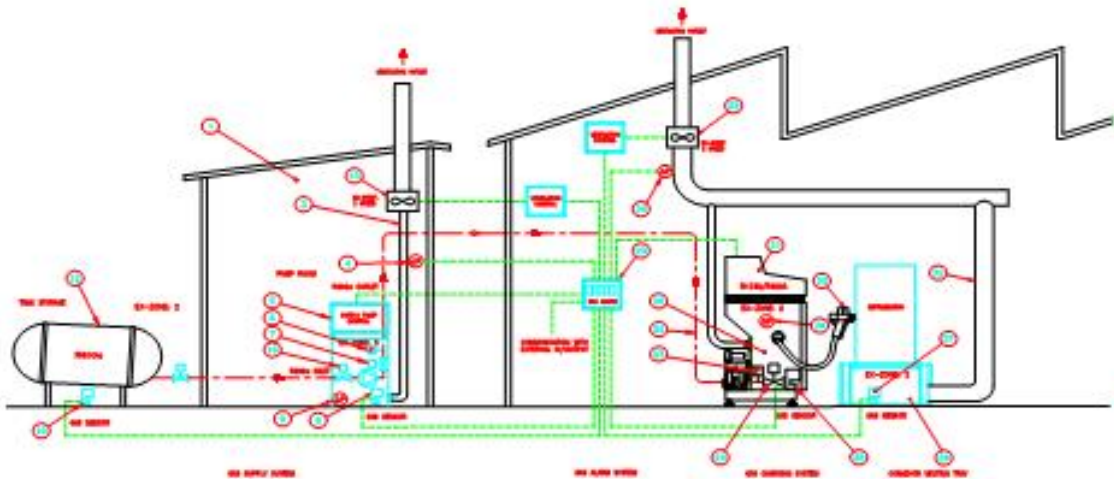

**R290 加液区**  
**R290 CHARGING STATION**

禁止吸烟  
No smoking

禁止明火  
No open fire

禁打手机  
No phone call

禁止危险品  
No dangerous goods

禁止穿化纤服装  
Prohibit wearing chemical fiber clothing

1. 本区域为防爆区域，用于充注易燃易爆冷媒R290;  
This is Explosion-proof area for filling of flammable media R290;

2. 本区域内严禁烟火;  
No smoking, no open fire;

3. 严禁在区内从事可能产生火花的作业;  
Works which may produce sparks prohibited;

4. 严禁在区内穿、脱和拍打化纤服装;  
No wearing, taking off or beating of chemical fiber clothing;

5. 不得携带危险品进入区内;  
Do not carry dangerous goods into the area;

6. 区内禁止使用手机。  
Do not use mobile phone in the area.



## 2. ZONING PLAN 分区

Zone 2: EX-Danger (exceptionally and only shortly)

二级危险区：仅当异常时出现且短暂的泄漏

Alarm Zone:

Electrical equipment min. IP54

Non Ex-approved components to be automatically switch off in case of gas alarm

报警区：电气设备最低IP54等级

当出现气体报警时非防爆设备/元件须自动断电

Fire safe: No use of open fire

无明火区：不能使用明火，以泄漏源为中心半径5米的空间。

Warning signs to be located in the area.

所有区域要有标识

## 2. ZONING PLAN 分区

### Zone Definition Station

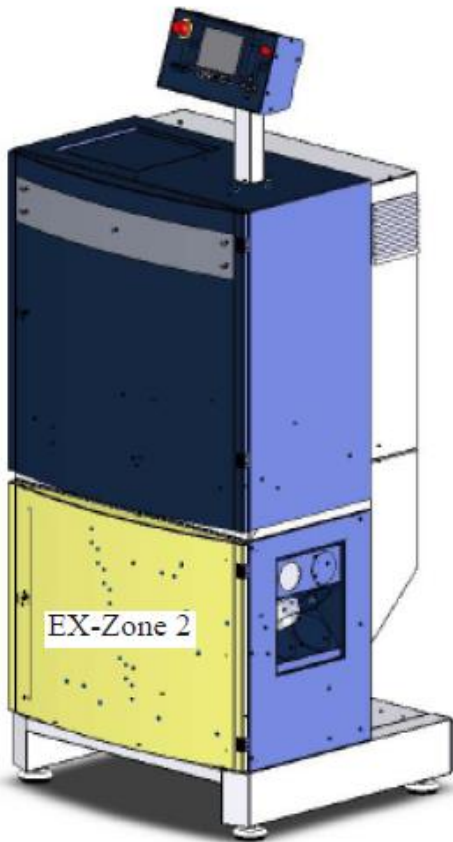

### Zone Definition Gun

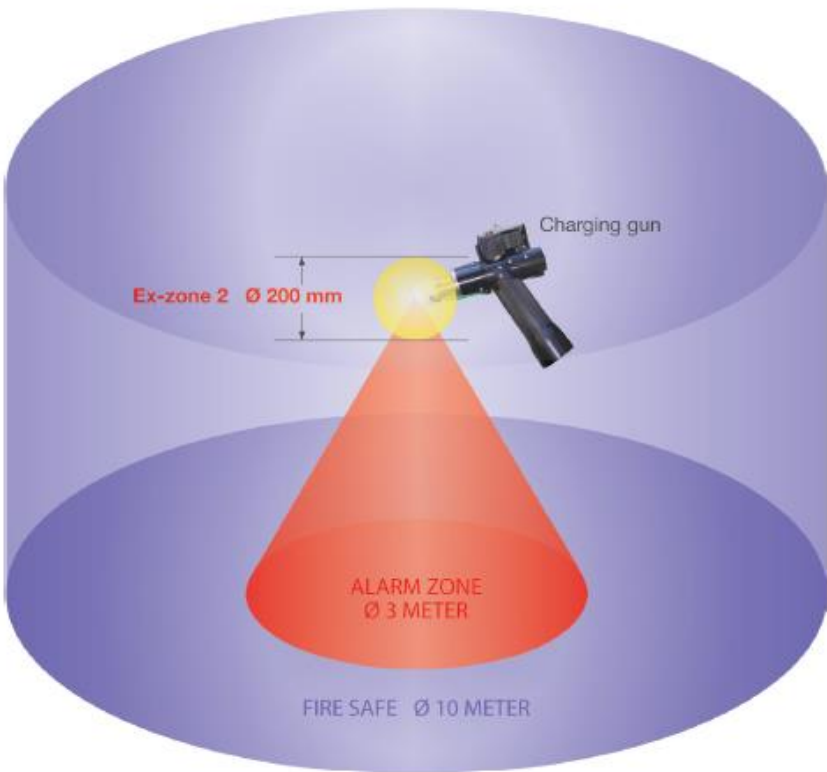

## 2. ZONING PLAN 分区

Conveyor EX-zone

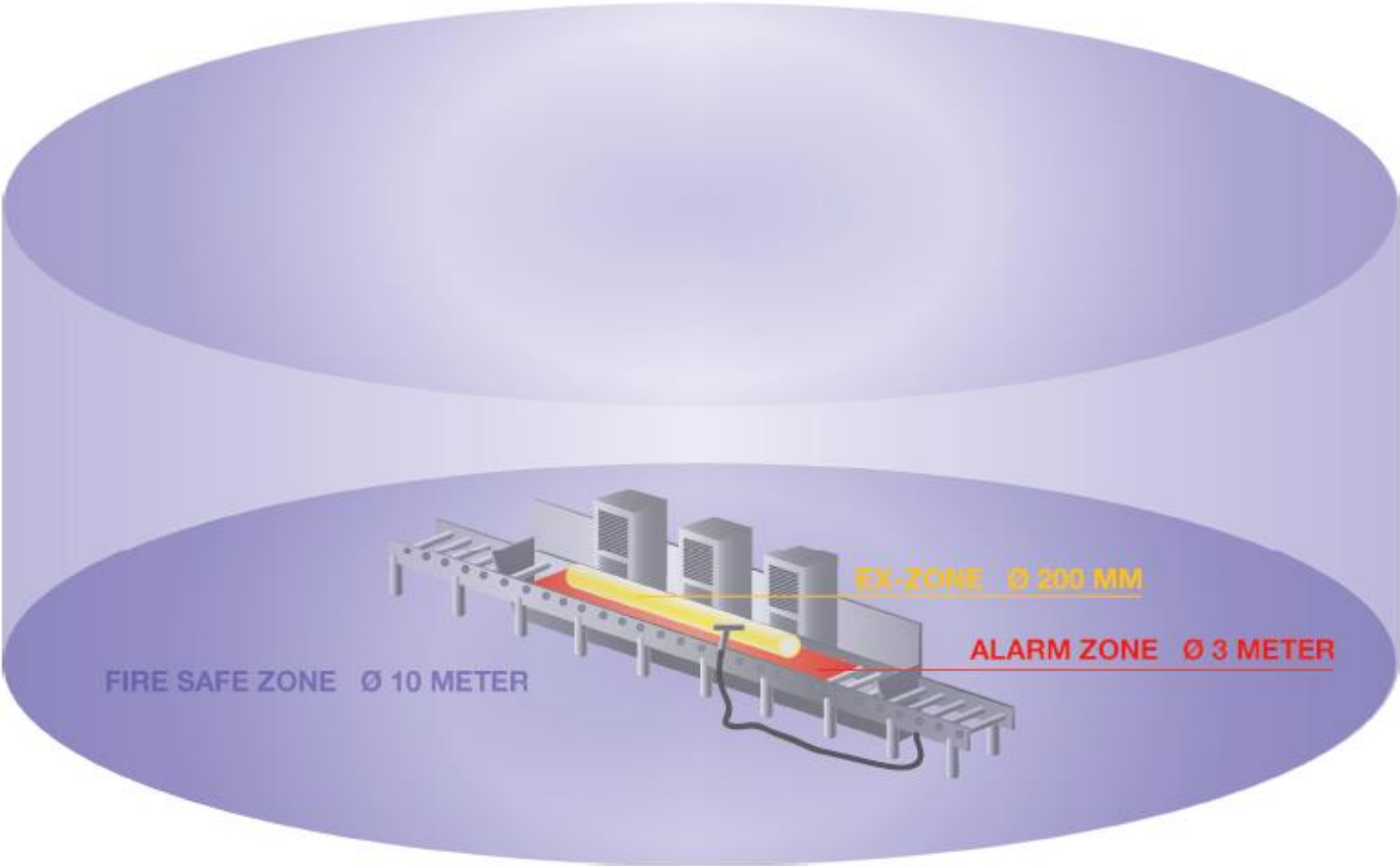

## 3. SAFETY MONITORING 安全监控系统

- **Safety system must comply with safety standard**  
安全系统必须符合安全标准
- **Gas sensor**  
气体传感器监测可能的气体泄漏
- **Delta P, Flow Switch**  
压差开关, 流量开关
- **Emergency Stop**  
急停开关
- **UPS**  
不间断电源
- **Communication matrix**  
功能确认

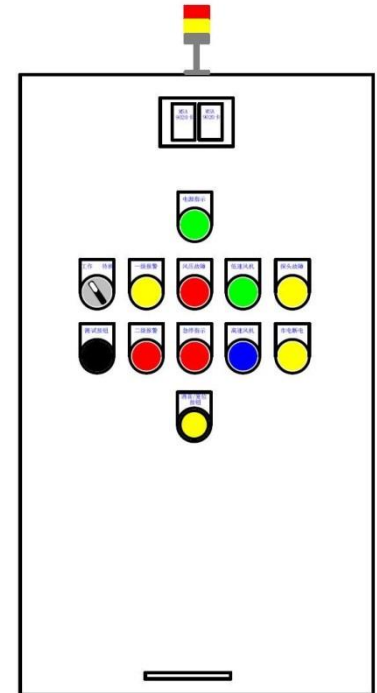



# 4. Charging 冷媒充注

## 国标要求:

- 必须选用带有国家认可标志的防爆认证灌注机
- 灌注机枪头应采用气动机械锁扣装置与空调器制冷剂管路连接，充注过程中避免互相脱离
- 灌注完成后，确保没有残余制冷剂释放到现场
- 当灌注机运行参数超出设置值时，设备通过声光报警来提示操作人员

## 我们的设备:

- 系统连接后首先判断自身真空是否合格，然后对公母接头空间进行抽真空；完成后才与空调管路连接，避免公母接头的空间破坏空调管路真空；也避免枪头未正确连接时充注冷媒。
- 充注完成后，设备先对枪头的残余冷媒进行回吸，回吸完成后（系统自动检测判断），自动与空调接头脱开，没有残余冷媒释放到现场。
- 充注速度: 40/60 g/s \* (R290)  
120 ~ 220 g/s (R32)
- 充注精度: +/- 0.5%

ZERTIFIKAT

CERTIFICATE

CERTIFICADO

CERTIFICAT

### CERTIFICATE

**TYPE EXAMINATION CERTIFICATE**

Equipment or Protective System intended for use in potentially explosive atmospheres Directive 2014/34/EU

Type Examination Certificate number: **TÜV IT 16 ATEX 051 X**

Equipment or Protective System: Evacuation and charging station  
Type: CEMAC-X

Manufacturer: Schenck Shanghai Machinery Co., Ltd.

Address: No. 1111, Fengxiang Road, Shanghai 200444, PR China

This equipment or protective system and any acceptable variation thereto is specified in the schedule to this certificate and the documents therein referred to.

TÜV Italia certifies that this equipment or protective system has been found to comply with the Essential Health and Safety Requirements relating to the design and construction of equipment and protective systems intended for use in potentially explosive atmospheres given in Annex II to the Directive.

The examination and test results are recorded in confidential report no. R 16 EX 039

Compliance with the Essential Health and Safety Requirements has been assured by compliance with:

EN 60079-0: 2012+A11:2013	EN 60079-11: 2012	EN 60079-15: 2010
EN 1127-1: 2011	EN ISO 80079-36: 2016	EN ISO 80079-37: 2016

If the sign "X" is placed after the certificate number, it indicates that the equipment or protective system is subject to special conditions for safe use specified in the schedule to this certificate.

This TYPE EXAMINATION CERTIFICATE relates only to the design, examination and tests of the specified equipment or protective system in accordance to the Directive 2014/34/EU. Further requirements of the Directive apply to the manufacturing process and supply of this equipment or protective system. These are not covered by this certificate.

The marking of the equipment or protective system shall include the following:

Ex

II -3G

Ex nA ic IIA T3 -Gc

II -3G

Ex h IIA T3 -Gc

This certificate may only be reproduced in its entirety and without any change, schedule included.

Issue date: 07th October 2016

ACCREDIA

ISO 9001:2015

ISO 14001:2015

ISO 45001:2018

ISO 50001:2018

ISO 55001:2018

ISO 59001:2018

ISO 60000:2018

ISO 60001:2018

ISO 60002:2018

ISO 60003:2018

ISO 60004:2018

ISO 60005:2018

ISO 60006:2018

ISO 60007:2018

ISO 60008:2018

ISO 60009:2018

ISO 60010:2018

ISO 60011:2018

ISO 60012:2018

ISO 60013:2018

ISO 60014:2018

ISO 60015:2018

ISO 60016:2018

ISO 60017:2018

ISO 60018:2018

ISO 60019:2018

ISO 60020:2018

ISO 60021:2018

ISO 60022:2018

ISO 60023:2018

ISO 60024:2018

ISO 60025:2018

ISO 60026:2018

ISO 60027:2018

ISO 60028:2018

ISO 60029:2018

ISO 60030:2018

ISO 60031:2018

ISO 60032:2018

ISO 60033:2018

ISO 60034:2018

ISO 60035:2018

ISO 60036:2018

ISO 60037:2018

ISO 60038:2018

ISO 60039:2018

ISO 60040:2018

ISO 60041:2018

ISO 60042:2018

ISO 60043:2018

ISO 60044:2018

ISO 60045:2018

ISO 60046:2018

ISO 60047:2018

ISO 60048:2018

ISO 60049:2018

ISO 60050:2018

ISO 60051:2018

ISO 60052:2018

ISO 60053:2018

ISO 60054:2018

ISO 60055:2018

ISO 60056:2018

ISO 60057:2018

ISO 60058:2018

ISO 60059:2018

ISO 60060:2018

ISO 60061:2018

ISO 60062:2018

ISO 60063:2018

ISO 60064:2018

ISO 60065:2018

ISO 60066:2018

ISO 60067:2018

ISO 60068:2018

ISO 60069:2018

ISO 60070:2018

ISO 60071:2018

ISO 60072:2018

ISO 60073:2018

ISO 60074:2018

ISO 60075:2018

ISO 60076:2018

ISO 60077:2018

ISO 60078:2018

ISO 60079:2018

ISO 60080:2018

ISO 60081:2018

ISO 60082:2018

ISO 60083:2018

ISO 60084:2018

ISO 60085:2018

ISO 60086:2018

ISO 60087:2018

ISO 60088:2018

ISO 60089:2018

ISO 60090:2018

ISO 60091:2018

ISO 60092:2018

ISO 60093:2018

ISO 60094:2018

ISO 60095:2018

ISO 60096:2018

ISO 60097:2018

ISO 60098:2018

ISO 60099:2018

ISO 60100:2018

ISO 60101:2018

ISO 60102:2018

ISO 60103:2018

ISO 60104:2018

ISO 60105:2018

ISO 60106:2018

ISO 60107:2018

ISO 60108:2018

ISO 60109:2018

ISO 60110:2018

ISO 60111:2018

ISO 60112:2018

ISO 60113:2018

ISO 60114:2018

ISO 60115:2018

ISO 60116:2018

ISO 60117:2018

ISO 60118:2018

ISO 60119:2018

ISO 60120:2018

ISO 60121:2018

ISO 60122:2018

ISO 60123:2018

ISO 60124:2018

ISO 60125:2018

ISO 60126:2018

ISO 60127:2018

ISO 60128:2018

ISO 60129:2018

ISO 60130:2018

ISO 60131:2018

ISO 60132:2018

ISO 60133:2018

ISO 60134:2018

ISO 60135:2018

ISO 60136:2018

ISO 60137:2018

ISO 60138:2018

ISO 60139:2018

ISO 60140:2018

ISO 60141:2018

ISO 60142:2018

ISO 60143:2018

ISO 60144:2018

ISO 60145:2018

ISO 60146:2018

ISO 60147:2018

ISO 60148:2018

ISO 60149:2018

ISO 60150:2018

ISO 60151:2018

ISO 60152:2018

ISO 60153:2018

ISO 60154:2018

ISO 60155:2018

ISO 60156:2018

ISO 60157:2018

ISO 60158:2018

ISO 60159:2018

ISO 60160:2018

ISO 60161:2018

ISO 60162:2018

ISO 60163:2018

ISO 60164:2018

ISO 60165:2018

ISO 60166:2018

ISO 60167:2018

ISO 60168:2018

ISO 60169:2018

ISO 60170:2018

ISO 60171:2018

ISO 60172:2018

ISO 60173:2018

ISO 60174:2018

ISO 60175:2018

ISO 60176:2018

ISO 60177:2018

ISO 60178:2018

ISO 60179:2018

ISO 60180:2018

ISO 60181:2018

ISO 60182:2018

ISO 60183:2018

ISO 60184:2018

ISO 60185:2018

ISO 60186:2018

ISO 60187:2018

ISO 60188:2018

ISO 60189:2018

ISO 60190:2018

ISO 60191:2018

ISO 60192:2018

ISO 60193:2018

ISO 60194:2018

ISO 60195:2018

ISO 60196:2018

ISO 60197:2018

ISO 60198:2018

ISO 60199:2018

ISO 60200:2018

ISO 60201:2018

ISO 60202:2018

ISO 60203:2018

ISO 60204:2018

ISO 60205:2018

ISO 60206:2018

ISO 60207:2018

ISO 60208:2018

ISO 60209:2018

ISO 60210:2018

ISO 60211:2018

ISO 60212:2018

ISO 60213:2018

ISO 60214:2018

ISO 60215:2018

ISO 60216:2018

ISO 60217:2018

ISO 60218:2018

ISO 60219:2018

ISO 60220:2018

ISO 60221:2018

ISO 60222:2018

ISO 60223:2018

ISO 60224:2018

ISO 60225:2018

ISO 60226:2018

ISO 60227:2018

ISO 60228:2018

ISO 60229:2018

ISO 60230:2018

ISO 60231:2018

ISO 60232:2018

ISO 60233:2018

ISO 60234:2018

ISO 60235:2018

ISO 60236:2018

ISO 60237:2018

ISO 60238:2018

ISO 60239:2018

ISO 60240:2018

ISO 60241:2018

ISO 60242:2018

ISO 60243:2018

ISO 60244:2018

ISO 60245:2018

ISO 60246:2018

ISO 60247:2018

ISO 60248:2018

ISO 60249:2018

ISO 60250:2018

ISO 60251:2018

ISO 60252:2018

ISO 60253:2018

ISO 60254:2018

ISO 60255:2018

ISO 60256:2018

ISO 60257:2018

ISO 60258:2018

ISO 60259:2018

ISO 60260:2018

ISO 60261:2018

ISO 60262:2018

ISO 60263:2018

ISO 60264:2018

ISO 60265:2018

ISO 60266:2018

ISO 60267:2018

ISO 60268:2018

ISO 60269:2018

ISO 60270:2018

ISO 60271:2018

ISO 60272:2018

ISO 60273:2018

ISO 60274:2018

ISO 60275:2018

ISO 60276:2018

ISO 60277:2018

ISO 60278:2018

ISO 60279:2018

ISO 60280:2018

ISO 60281:2018

ISO 60282:2018

ISO 60283:2018

ISO 60284:2018

ISO 60285:2018

ISO 60286:2018

ISO 60287:2018

ISO 60288:2018

ISO 60289:2018

ISO 60290:2018

ISO 60291:2018

ISO 60292:2018

ISO 60293:2018

ISO 60294:2018

ISO 60295:2018

ISO 60296:2018

ISO 60297:2018

ISO 60298:2018

ISO 60299:2018

ISO 60300:2018

ISO 60301:2018

ISO 60302:2018

ISO 60303:2018

ISO 60304:2018

ISO 60305:2018

ISO 60306:2018

ISO 60307:2018

ISO 60308:2018

ISO 60309:2018

ISO 60310:2018

ISO 60311:2018

ISO 60312:2018

ISO 60313:2018

ISO 60314:2018

ISO 60315:2018

ISO 60316:2018

ISO 60317:2018

ISO 60318:2018

ISO 60319:2018

ISO 60320:2018

ISO 60321:2018

ISO 60322:2018

ISO 60323:2018

ISO 60324:2018

ISO 60325:2018

ISO 60326:2018

ISO 60327:2018

ISO 60328:2018

ISO 60329:2018

ISO 60330:2018

ISO 60331:2018

ISO 60332:2018

ISO 60333:2018

ISO 60334:2018

ISO 60335:2018

ISO 60336:2018

ISO 60337:2018

ISO 60338:2018

ISO 60339:2018

ISO 60340:2018

ISO 60341:2018

ISO 60342:2018

ISO 60343:2018

ISO 60344:2018

ISO 60345:2018

ISO 60346:2018

ISO 60347:2018

ISO 60348:2018

ISO 60349:2018

ISO 60350:2018

ISO 60351:2018

ISO 60352:2018

ISO 60353:2018

ISO 60354:2018

ISO 60355:2018

ISO 60356:2018

ISO 60357:2018

ISO 60358:2018

ISO 60359:2018

ISO 60360:2018

ISO 60361:2018

ISO 60362:2018

ISO 60363:2018

ISO 60364:2018

ISO 60365:2018

ISO 60366:2018

ISO 60367:2018

ISO 60368:2018

ISO 60369:2018

ISO 60370:2018

ISO 60371:2018

ISO 60372:2018

ISO 60373:2018

ISO 60374:2018

ISO 60375:2018

ISO 60376:2018

ISO 60377:2018

ISO 60378:2018

ISO 60379:2018

ISO 60380:2018

ISO 60381:2018

ISO 60382:2018

ISO 60383:2018

ISO 60384:2018

ISO 60385:2018

ISO 60386:2018

ISO 60387:2018

ISO 60388:2018

ISO 60389:2018

ISO 60390:2018

ISO 60391:2018

ISO 60392:2018

ISO 60393:2018

ISO 60394:2018

ISO 60395:2018

ISO 60396:2018

ISO 60397:2018

ISO 60398:2018

ISO 60399:2018

ISO 60400:2018

ISO 60401:2018

ISO 60402:2018

ISO 60403:2018

ISO 60404:2018

ISO 60405:2018

ISO 60406:2018

ISO 60407:2018

ISO 60408:2018

ISO 60409:2018

ISO 60410:2018

ISO 60411:2018

ISO 60412:2018

ISO 60413:2018

ISO 60414:2018

ISO 60415:2018

ISO 60416:2018

ISO 60417:2018

ISO 60418:2018

ISO 60419:2018

ISO 60420:2018

ISO 60421:2018

ISO 60422:2018

ISO 60423:2018

ISO 60424:2018

ISO 60425:2018

ISO 60426:2018

ISO 60427:2018

ISO 60428:2018

ISO 60429:2018

ISO 60430:2018

ISO 60431:2018

ISO 60432:2018

ISO 60433:2018

ISO 60434:2018

ISO 60435:2018

ISO 60436:2018

ISO 60437:2018

ISO 60438:2018

ISO 60439:2018

ISO 60440:2018

ISO 60441:2018

ISO 60442:2018

ISO 60443:2018

ISO 60444:2018

ISO 60445:2018

ISO 60446:2018

ISO 60447:2018

ISO 60448:2018

ISO 60449:2018

ISO 60450:2018

ISO 60451:2018

ISO 60452:2018

ISO 60453:2018

ISO 60454:2018

ISO 60455:2018

ISO 60456:2018

ISO 60457:2018

ISO 60458:2018

ISO 60459:2018

ISO 60460:2018

ISO 60461:2018

ISO 60462:2018

ISO 60463:2018

ISO 60464:2018

ISO 60465:2018

ISO 60466:2018

ISO 60467:2018

ISO 60468:2018

ISO 60469:2018

ISO 60470:2018

ISO 60471:2018

ISO 60472:2018

ISO 60473:2018

ISO 60474:2018

ISO 60475:2018

ISO 60476:2018

ISO 60477:2018

ISO 60478:2018

ISO 60479:2018

ISO 60480:2018

ISO 60481:2018

ISO 60482:2018

ISO 60483:2018

ISO 60484:2018

ISO 60485:2018

ISO 60486:2018

ISO 60487:2018

ISO 60488:2018

ISO 60489:2018

ISO 60490:2018

ISO 60491:2018

ISO 60492:2018

ISO 60493:2018

ISO 60494:2018

ISO 60495:2018

ISO 60496:2018

ISO 60497:2018

ISO 60498:2018

ISO 60499:2018

ISO 60500:2018

ISO 60501:2018

ISO 60502:2018

ISO 60503:2018

ISO 60504:2018

ISO 60505:2018

ISO 60506:2018

ISO 60507:2018

ISO 60508:2018

ISO 60509:2018

ISO 60510:2018

ISO 60511:2018

ISO 60512:2018

ISO 60513:2018

ISO 60514:2018

ISO 60515:2018

ISO 60516:2018

ISO 60517:2018

ISO 60518:2018

ISO 60519:2018

ISO 60520:2018

ISO 60521:2018

ISO 60522:2018

ISO 60523:2018

ISO 60524:2018

ISO 60525:2018

ISO 60526:2018

ISO 60527:2018

ISO 60528:2018

ISO 60529:2018

ISO 60530:2018

ISO 60531:2018

ISO 60532:2018

ISO 60533:2018

ISO 60534:2018

ISO 60535:2018

ISO 60536:2018

ISO 60537:2018

ISO 60538:2018

ISO 60539:2018

ISO 60540:2018

ISO 60541:2018

ISO 60542:2018

ISO 60543:2018

ISO 60544:2018

ISO 60545:2018

ISO 60546:2018

ISO 60547:2018

ISO 60548:2018

ISO 60549:2018

ISO 60550:2018

ISO 60551:2018

ISO 60552:2018

ISO 60553:2018

ISO 60554:2018

ISO 60555:2018

ISO 60556:2018

ISO 60557:2018

ISO 60558:2018

ISO 60559:2018

ISO 60560:2018

ISO 60561:2018

ISO 60562:2018

ISO 60563:2018

ISO 60564:2018

ISO 60565:2018

ISO 60566:2018

ISO 60567:2018

ISO 60568:2018

ISO 60569:2018

ISO 60570:2018

ISO 60571:2018

ISO 60572:2018

ISO 60573:2018

ISO 60574:2018

ISO 60575:2018

ISO 60576:2018

ISO 60577:2018

ISO 60578:2018

ISO 60579:2018

ISO 60580:2018

ISO 60581:2018

ISO 60582:2018

ISO 60583:2018

ISO 60584:2018

ISO 60585:2018

ISO 60586:2018

ISO 60587:2018

ISO 60588:2018

ISO 60589:2018

ISO 60590:2018

ISO 60591:2018

ISO 60592:2018

ISO 60593:2018

ISO 60594:2018

ISO 60595:2018

ISO 60596:2018

ISO 60597:2018

ISO 60598:2018

ISO 60599:2018

ISO 60600:2018

ISO 60601:2018

ISO 60602:2018

ISO 60603:2018

ISO 60604:2018

ISO 60605:2018

ISO 60606:2018

ISO 60607:2018

ISO 60608:2018

ISO 60609:2018

ISO 60610:2018

ISO 60611:2018

ISO 60612:2018

ISO 60613:2018

ISO 60614:2018

ISO 60615:2018

ISO 60616:2018

ISO 60617:2018

ISO 60618:2018

ISO 60619:2018

ISO 60620:2018

ISO 60621:2018

ISO 60622:2018

ISO 60623:2018

ISO 60624:2018

ISO 60625:2018

ISO 60626:2018

ISO 60627:2018

ISO 60628:2018

ISO 60629:2018

ISO 60630:2018

ISO 60631:2018

ISO 60632:2018

ISO 60633:2018

ISO 60634:2018

ISO 60635:2018

ISO 60636:2018

ISO 60637:2018

ISO 60638:2018

ISO 60639:2018

ISO 60640:2018

ISO 60641:2018

ISO 60642:2018

ISO 60643:2018

ISO 60644:2018

ISO 60645:2018

ISO 60646:2018

ISO 60647:2018

ISO 60648:2018</





## 4. Charging 冷媒充注

### 国标要求:

- 必须选用带有国家认可标志的防爆认证灌注机
- 灌注机枪头应采用气动机械锁扣装置与空调器制冷剂管路连接，充注过程中避免互相脱离
- 灌注完成后，确保没有残余制冷剂释放到现场
- 当灌注机运行参数超出设置值时，设备通过声光报警来提示操作人员

### 我们的设备:

- 系统连接后首先判断自身真空是否合格，然后对公母接头空间进行抽真空；完成后才与空调管路连接，避免公母接头的空间破坏空调管路真空；也避免枪头未正确连接时充注冷媒。
- 充注完成后，设备先对枪头的残余冷媒进行回吸，回吸完成后（系统自动检测判断），自动与空调接头脱开，没有残余冷媒释放到现场。
- 充注速度: 40/60 g/s \* (R290)  
120 ~ 220 g/s (R32)
- 充注精度: +/- 0.5%



## 4. Charging 冷媒充注

为什么要使用自动脱枪(ADC)?

ADC: **A**uto-**D**is**C**onnection

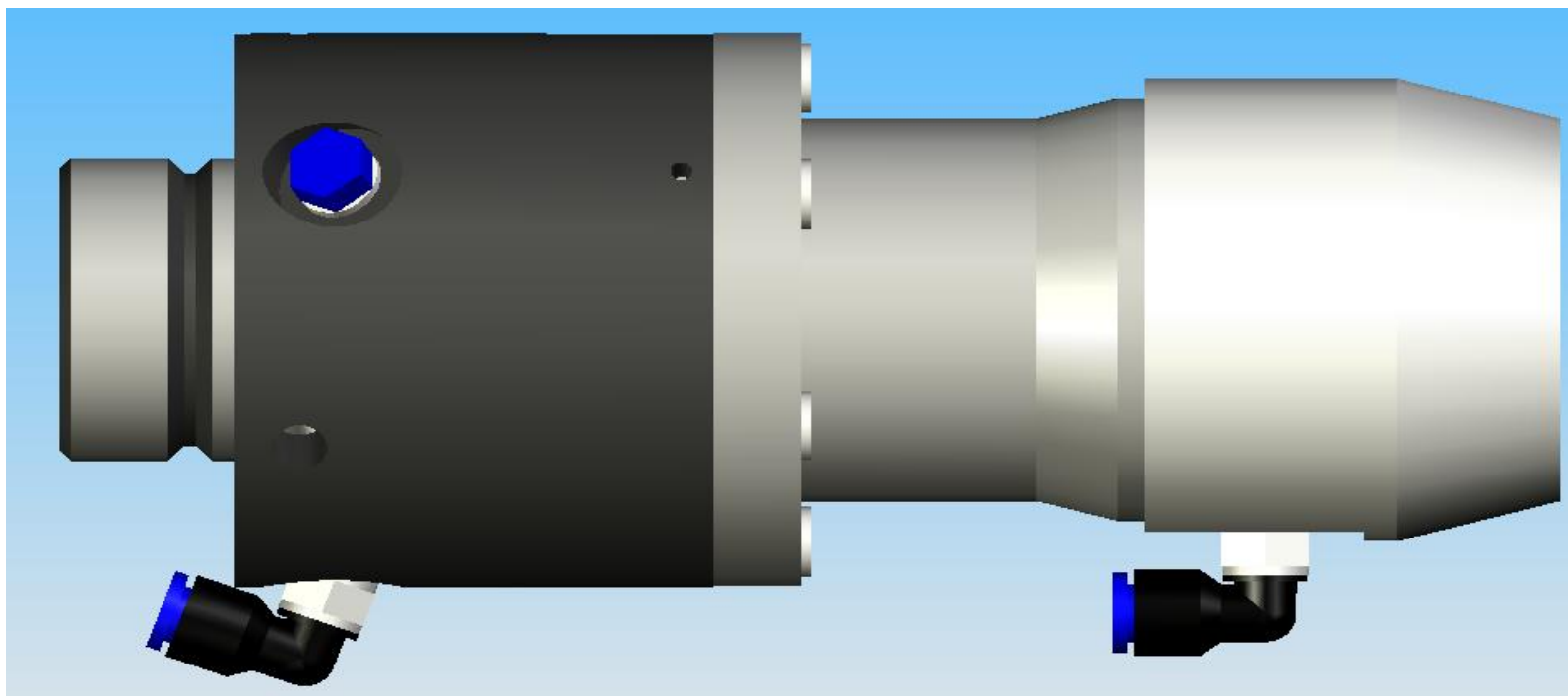
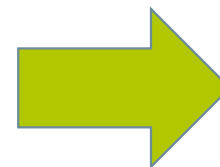
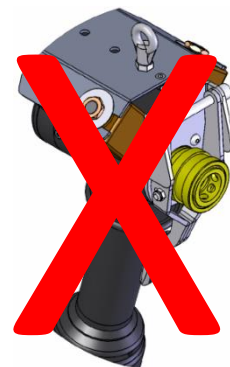

## 4. Charging 冷媒充注

为什么要使用自动脱枪(ADC)?

ADC: **A**uto-**D**is**C**onnection

- 系统连接后首先对公母接头空间进行抽真空，完成后才与空调管路连接；避免公母接头的空间破坏空调管路真空，也确保连接可靠。
- 充注完成后，设备先对枪头的残余冷媒进行回吸，回吸完成后（系统自动检测判断），自动与空调接头脱开，没有残余冷媒释放到现场。

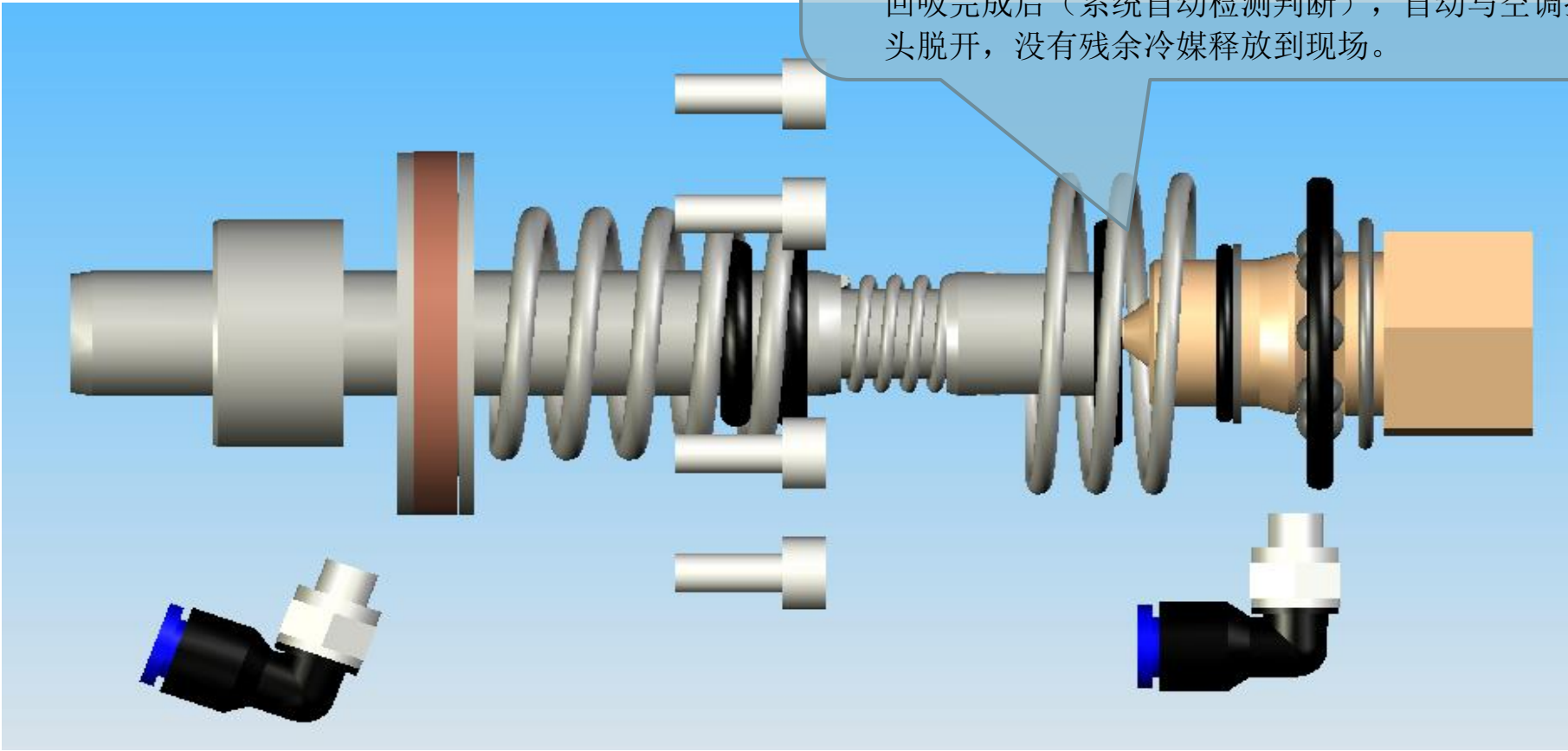





## 5. POWER CONTROL CABINET 电源控制

➤ **Uninterrupted power supply**

不间断电源

- **Safety system**

安全系统

- **Ventilation system**

通风系统

➤ **Power cut-off**

报警时切断电源

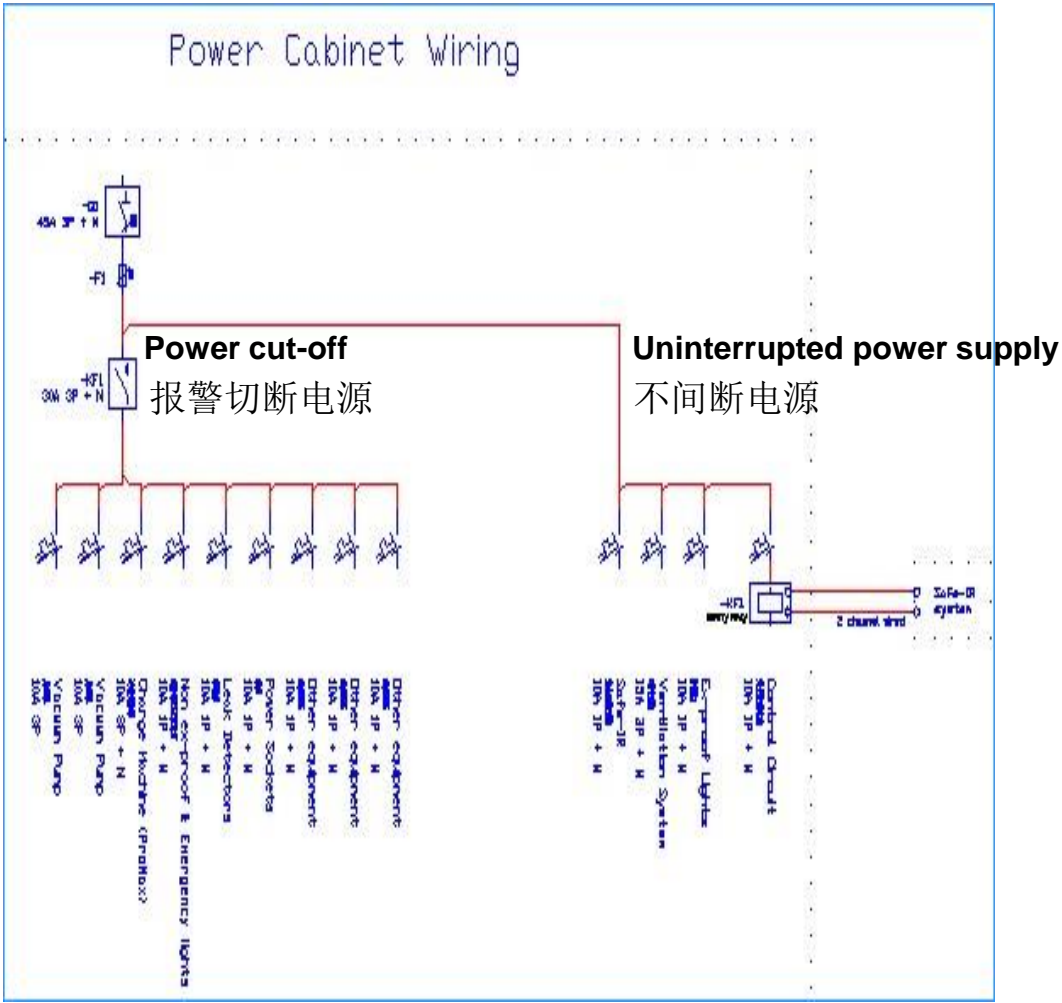

## 6. VENTILATION 通风系统

- Qualified supplier
- 合格的供应商（资质）
- Design capacity and ducting per layout and site situation
- 根据线体图纸和实际场地设计通风方案
- Ex proof centrifugal ventilators
- 防爆离心风机，一用一备
- Interaction with safety system
- 安全系统与通风系统通讯
- 24-hour or stand-by
- 24小时运转或待机模式
- Lightning rod
- 避雷针
- Grounding
- 接地连接
- Test Report
- 检测报告





